

220 SERIES stepper motor pump without driver

Williamson
UK manufacturers of quality peristaltic pumps

- Long Life Brushless Motor
- Various Tube Materials/Sizes
- 2,3,4 or 6 Rollers
- Integral Tube Grips
- Easy Tube Change



The 220 series stepper driven peristaltic pump offers a compact & reliable means of dosing a wide range of liquids. They are available in various tube materials and number of rollers giving flow rates of between 0.6 & 1.32 ml/rev.

The pump head tubing is easily changed by sliding up and removing the pump cover.

DIMENSIONS (mm)

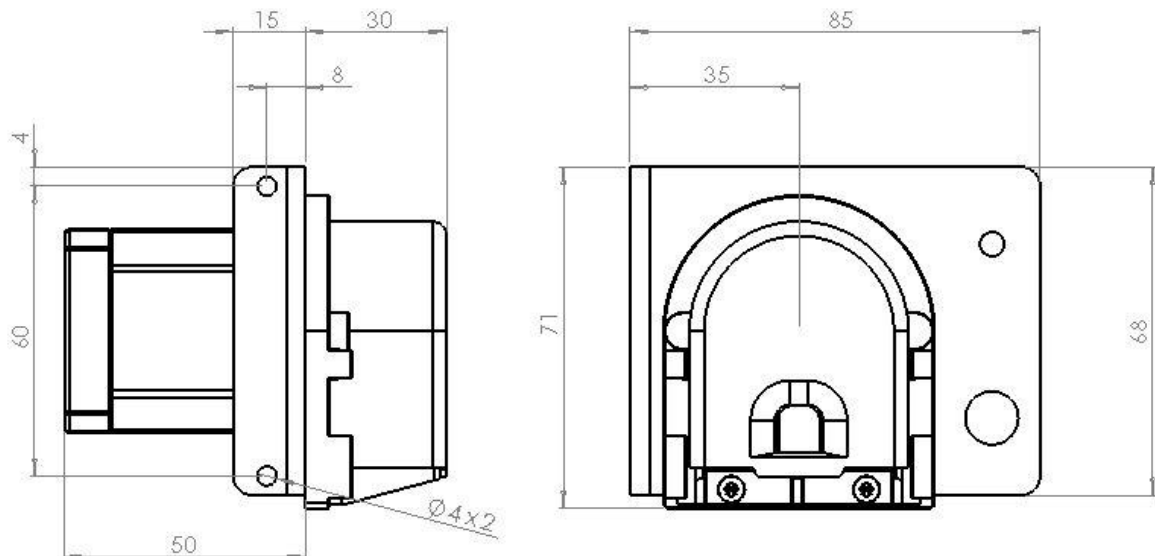

The Williamson Manufacturing Company Ltd provides no warranty on usage of pumps. We recommend that life tests be carried out prior to use. This information is given in good faith and believed to be correct at the time of publishing. The Williamson Manufacturing Company Ltd cannot accept responsibility for inaccuracy or any errors contained herein. Copyright the Williamson Manufacturing Company Ltd 2008.

Williamson Manufacturing Co Ltd
Unit 5, Lady Bee Industrial Estate
Albion Street South wick
West Sussex
BN42 4EP UK
Email: sales@williamsonpumps.co.uk

220 SERIES stepper motor pump without driver

Devise your product code by using codes from the table on the right where stated below.

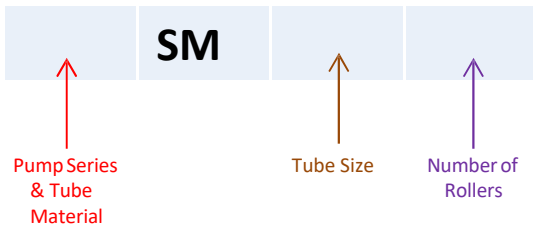

	Product code
Pump series and tube material	
Silicone (Peroxide Cured)	220
Tygon® A60F Norprene	221
Viton®	222
Tygon Chemical® Norprene (3mm & 5mm only)	227
Tube Size (bore) mm	
5.0	-050
Number of rollers	
2	/2
3 (Supplied as standard)	/3
4	/4
6	/6

222-SM-050/3

Example product code for 220 series pump head fitted with Viton® tubing, stepper motor, 5mm ID tubing & 3 rollers

Stepper Motor Specification

Step Angle	1.8 Degrees
Step Angle Accuracy.	5%
Phase Current	1.5 A
Phase resistance	2 ohms
Phase inductance	3.85 mH
Detent torque	2.4 Ncm
Rotor inertia	82 g/cm ²
Insulation class	B
Number of leads	4

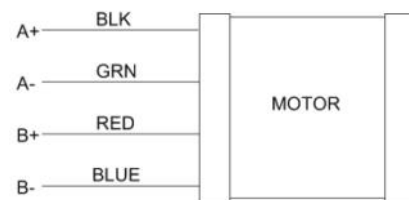

MOTOR ONLY

Flow Rates ml per revolution

Flow rates based on silicone tubing. Flow rates for Tygon A60F® will be approx. 10% less, Tygon Chemical® & Viton® will be 20-25% less.

No of Rollers	5.0 ID tube
2	1.32
3	1.18
4	0.94
6	0.6

Note: 150 is the maximum suggested RPM

Flow rates for guidance only and subject to tube tolerance, tube age, fluid viscosity & back pressure.

The Williamson Manufacturing Company Ltd provides no warranty on usage of pumps. We recommend that life tests be carried out prior to use. This information is given in good faith and believed to be correct at the time of publishing. The Williamson Manufacturing Company Ltd cannot accept responsibility for inaccuracy or any errors contained herein. Copyright the Williamson Manufacturing Company Ltd 2008.

Williamson Manufacturing Co Ltd
Unit 5, Lady Bee Industrial Estate
Albion Street South wick
West Sussex
BN42 4EP UK
Email: sales@williamsonpumps.co.uk